



## Brass pressure fittings

# 90° coupling

## ITEM 152

REFERENCE	DESCRIPTION	Net weight	Volumen (m <sup>3</sup> )	Gross weight	Unidades lote
1020001	BRASS 90° ELBOW 20	0,1559	0,01553	12,8	80
1020002	BRASS 90° ELBOW 25	0,2523	0,01553	10,42	40
1020003	BRASS 90° ELBOW 32	0,3715	0,01553	17,045	45
1020004	BRASS 90° ELBOW 40	0,6091	0,01553	14,945	24
1020005	BRASS 90° ELBOW 50	0,993644	0,01553	16,225	16
1020006	BRASS 90° ELBOW 63	1,5507	0,02244	15,995	10
1020007	BRASS 90° ELBOW 75	2,5129	0,02244	10,592	4
1020008	BRASS 90° ELBOW 90	3,3075	0,01553	6,855	2



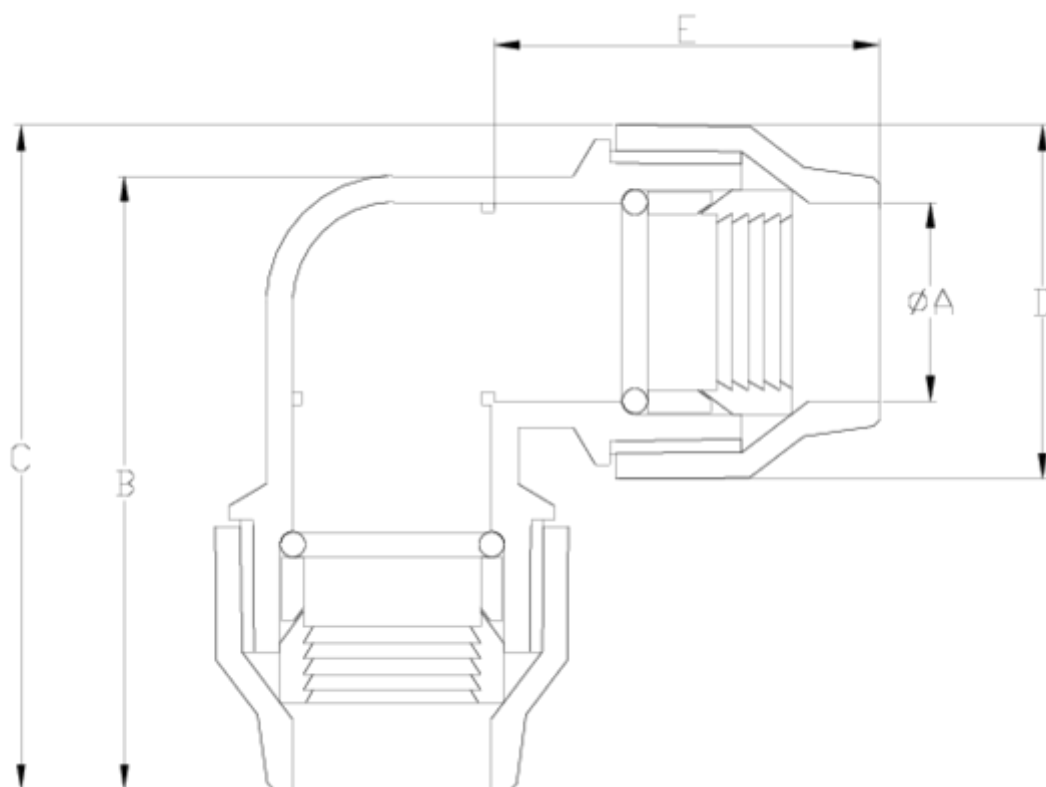

## ITEM 152 | 90° coupling

Código	f tubo	Peso (g)	A	B	C	D	E	PN	MEDIDA
20001	20	175	21	58	64	35	32.5	PN25	MÉTRICO
20002	25	296	26	64.3	71.2	41.5	36	PN25	MÉTRICO
20003	32	376	33	72.2	85.3	49.5	43	PN25	MÉTRICO
20004	40	699	41.8	92.5	99.1	61	48	PN25	MÉTRICO
20005	50	1050	51.2	107.5	116.5	74.3	55.5	PN25	MÉTRICO
20006	63	1713	64	133	145	91.2	64	PN25	MÉTRICO
20007	75	2510	135	115.8				PN25	MÉTRICO
20008	90	3750	154	133.4				PN25	MÉTRICO



## Product Documents



## Product Certificates

## Company Certificates

