



## Brass pressure fittings

# Straight coupling

## ITEM 149

REFERENCE	DESCRIPTION	Net weight	Volumen (m <sup>3</sup> )	Gross weight	Unidades lote
1020019	BRASS STRAIGHT COUPLING 20	0,1199	0,00892	6,18	50
1020020	BRASS STRAIGHT COUPLING 25	0,2014	0,00892	7,235	35
1020021	BRASS STRAIGHT COUPLING 32	0,323726	0,01553	16,513	50
1020022	BRASS STRAIGHT COUPLING 40	0,4844	0,01553	17,765	36
1020023	BRASS STRAIGHT COUPLING 50	0,7586	0,01553	12,465	16
1020024	BRASS STRAIGHT COUPLING 63	1,3463	0,01553	13,79	10
1020025	BRASS STRAIGHT COUPLING 75	2,547217	0,01553	15,61	6
1020026	BRASS STRAIGHT COUPLING 90	3,087	0,02244	19,062	6
1020027	BRASS STRAIGHT COUPLING,110	5,6638	0,00892	11,515	2



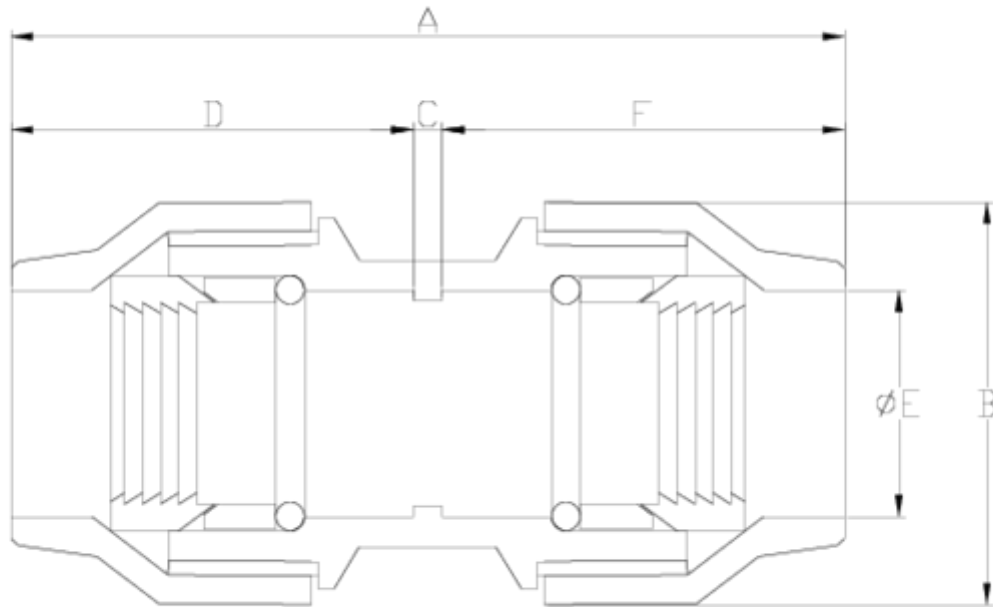

## ITEM 149 | Straight coupling

Código	f tubo	Peso (g)	A	B	C	D	E	F	PN	MEDIDA
20019	20	151	71	35	5.7	32.6	21	32.6	PN25	MÉTRICO
20020	25	245	73.3	41.5	2.3	35.5	26	35.5	PN25	MÉTRICO
20021	32	308	87.2	49.5	2.4	42.4	33	42.4	PN25	MÉTRICO
20022	40	556	101	61	2	49.5	41.8	49.5	PN25	MÉTRICO
20023	50	837	105	74.3	1.4	51.8	51.2	51.8	PN25	MÉTRICO
20024	63	1350	135	91.2	4	65.5	64	65.5	PN25	MÉTRICO
20025	75	2330	135	88	150.6				PN25	MÉTRICO
20026	90	3350	154	104	169.8				PN25	MÉTRICO
20027	110	4950	179	129	220				PN25	MÉTRICO



## Product Documents



## Product Certificates

## Company Certificates

