



"Ball" Check valve

Check valve "Ball" solvent socket outlet ITEM 635



REFERENCE	DESCRIPTION	Net weight	Volumen (m ³)	Gross weight	Unidades lote
1022003	BALL CHECK V. SOLV. SOCKET 32	0,358665	0,02244	7,661	20
1022004	BALL CHECK V. SOLV. SOCKET 40	0,507	0,03129	8,178	15
1022005	BALL CHECK V. SOLV. SOCKET 50	0,90572	0,04717	14,2276	15
1022006	BALL CHECK V. SOLV. SOCKET 63	1,501825	0,02244	6,495	4
1022007	BALL CHECK V. SOLV. SOCKET 75	2,2942	0,03129	9,805	4
1022008	BALL CHECK V. SOLV. SOCKET 90	3,8147	0,03129	8,23	2

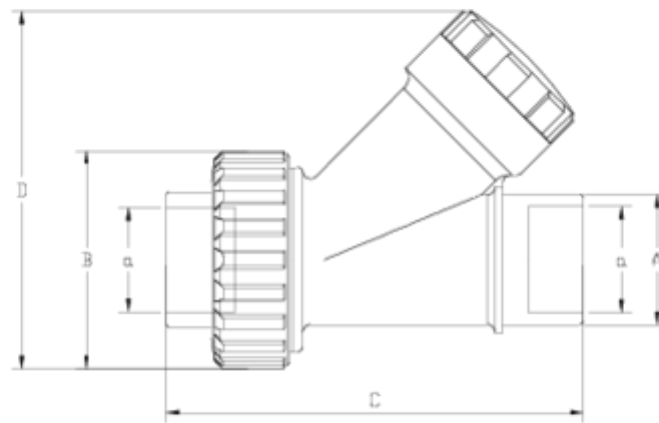

ITEM 635 | Check valve "Ball" solvent socket outlet

CÓDIGO	a	Peso (g)	DN	A	B	C	D	PN	MEDIDA
22003	32	335	25	40	72	140	127	PN10	MÉTRICO
22004	40	525	32	50	88	161	145	PN10	MÉTRICO
22005	50	840	40	63	103	181	170	PN10	MÉTRICO
22006	63	1450	50	75	120	218	220	PN10	MÉTRICO
22007	75	2380	65	90	150	261	255	PN10	MÉTRICO
22008	90	3835	80	110	181	325	280	PN10	MÉTRICO



Product Documents



Product Certificates



Company Certificates

