



## 'Compact' ball valves

# Male-Female threaded outlet

## ITEM 569

| REFERENCE | DESCRIPTION                         | Net weight | Volumen (m <sup>3</sup> ) | Gross weight | Unidades lote |
|-----------|-------------------------------------|------------|---------------------------|--------------|---------------|
| 111C030   | GFPP COMP.B.VALV. FEM- MALE O. 1/2" | 0,1064     | 0,00892                   | 2,365        | 20            |
| 111C031   | GFPP COMP.B.VALV. FEM- MALE O. 3/4" | 0,13663    | 0,00892                   | 2,97         | 20            |
| 111C032   | GFPP COMP.B.V.1" FEM- MALE O.       | 0,20072    | 0,01553                   | 3,375        | 15            |
| 111C033   | GFPP COMP.B.V.1 1/4" FEM- MALE O.   | 0,323      | 0,02244                   | 5,34         | 15            |
| 111C034   | GFPP COMP.B.V.1 1/2" FEM- MALE O.   | 0,4502     | 0,02243                   | 5,075        | 10            |
| 111C035   | GFPP COMP.B.V.2" FEM- MALE O.       | 0,7414     | 0,02243                   | 4,28         | 5             |



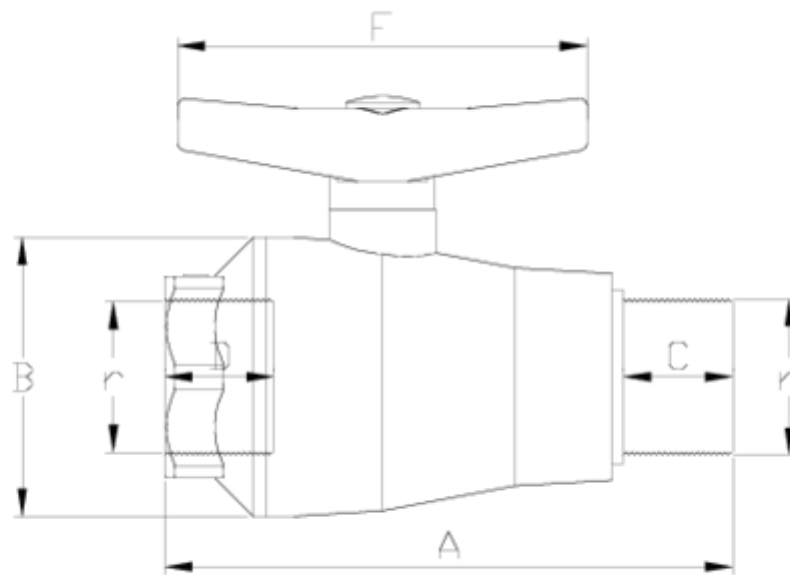

## ITEM 569 | Male-Female threaded outlet

| CÓDIGO | d-r       | DN | PESO (g) | A   | B   | C  | D  | F   | PN   | TIPO ROSCA |
|--------|-----------|----|----------|-----|-----|----|----|-----|------|------------|
| 11C040 | 20-1/2"   | 15 | 122      | 166 | 48  | 65 | 17 | 80  | PN10 | BSP        |
| 11C041 | 25-3/4"   | 20 | 149.38   | 178 | 53  | 65 | 20 | 80  | PN10 | BSP        |
| 11C042 | 32-1"     | 25 | 249      | 197 | 60  | 73 | 23 | 101 | PN10 | BSP        |
| 11C043 | 40-1 1/4" | 32 | 381      | 222 | 74  | 81 | 26 | 130 | PN10 | BSP        |
| 11C044 | 50-1 1/2" | 40 | 567      | 240 | 87  | 80 | 33 | 130 | PN10 | BSP        |
| 11C045 | 63-2"     | 50 | 1016     | 276 | 104 | 89 | 39 | 150 | PN10 | BSP        |



## Product Documents



## Product Certificates

## Company Certificates

