



Netvitc System pressure fittings

GFPP "AIR" Netvitc System

90° elbow

ITEM 28N

REFERENCE	DESCRIPTION	Net weight	Volumen (m ³)	Gross weight	Unidades lote
101N305	PP "AIR" NETVITC SYSTEM 90° ELBOW 63-1/2"	0,26	0,02243	3,09	10
101N307	PP "AIR" NETVITC SYSTEM 90° ELBOW 90-3/4"	0,6842	0,03682	6,0228	8
101N309	PP "AIR" NETVITC SYSTEM 90° ELBOW 110-1"	1,01915	0,04717	8,795	8
101N310	PP "AIR" NETVITC SYSTEM 90° ELBOW 125-2"	1,299917	0,06150	8,72	6
101N312	PP "AIR" NETVITC SYSTEM 90° ELBOW 160-2"	2,51	0,03682	5,69	2
101N313	PP "AIR" NETVITC SYSTEM 90° ELBOW 200-2"	3,925	0,06347	8,511	2



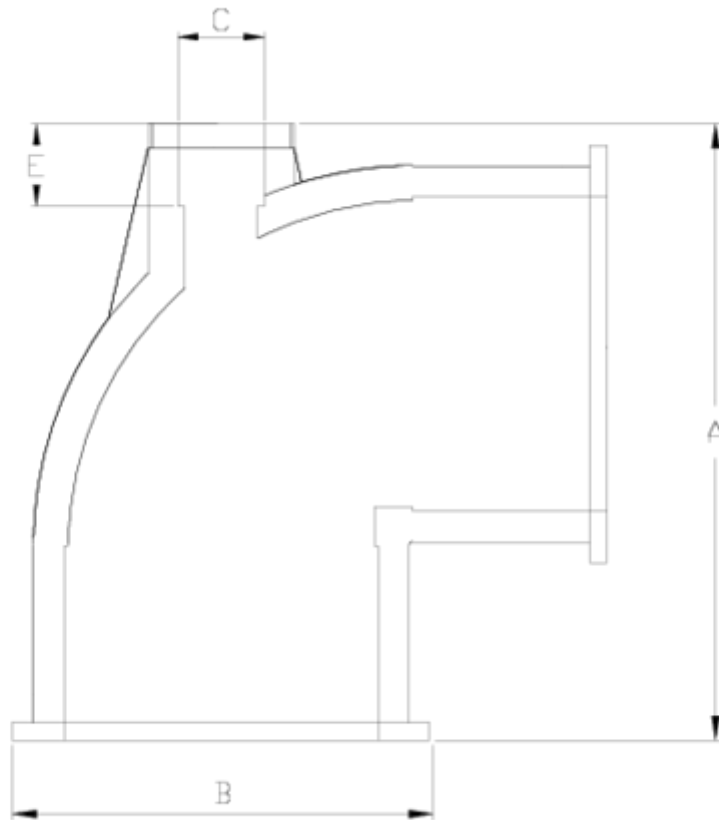

ITEM 28N | GFPP "AIR" Netvitc System 90° elbow

CÓDIGO	Ø	PESO	BRIDA	A	B	C	D	E	PN	MEDIDA
1N305	63	260	63	128	92	43	1/2"	17	PN10	MÉTRICO
1N307	90	604	90	174	121	50	3/4"	21	PN10	MÉTRICO
1N309	110	1019	110	204	144	61	1"	31	PN10	MÉTRICO
1N310	125	1300	125	245	159	70	2"	36	PN10	MÉTRICO
1N312	160	2510	160	299	201	87	2"	36	PN10	MÉTRICO
1N313	200	3925	200	347	251	106	2"	36	PN10	MÉTRICO



Product Documents



Product Certificates

Company Certificates

