



## Netvitic System pressure fittings

# PVC Netvitic System 90° elbow C/B

## ITEM 02N

REFERENCE	DESCRIPTION	Net weight	Volumen (m <sup>3</sup> )	Gross weight	Unidades lote
101N015	NETVITC SYSTEM 90° ELBOW 63 W/F	0,854	0,01553	3,74	4
101N017	NETVITC SYSTEM 90° ELBOW 90 W/F	2,116175	0,03682	9,04	4
101N018	NETVITC SYSTEM 90° ELBOW 110 W/F	3,05	0,06150	13,12	4
101N019	NETVITC SYSTEM 90° ELBOW 125 W/F	3,87475	0,03682	8,2987	2
101N020	SNS PVC 90° ELBOW W/FLANGE 140	5,547	0,03129	6,135	1
101N021	NETVITC SYSTEM 90° ELBOW W/F 160	7,5599	0,04879	8,225	1
101N022	NETVITC SYSTEM 90° ELBOW W/F 200	11,625	0,06879	12,3	1



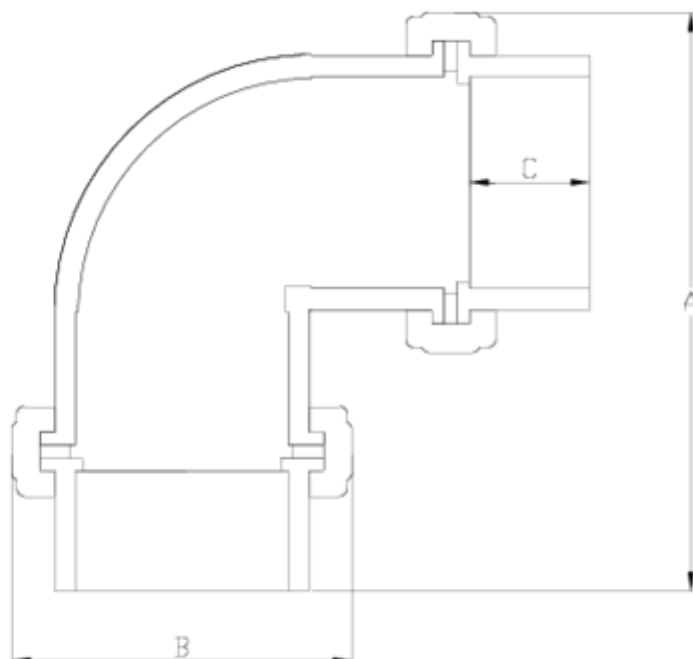

## ITEM 02N | PVC Netvicc System 90° elbow C/B

CÓDIGO	f	PESO	BRIDA	A	B	C	PN	MEDIDA
1N015	63	854	63	179.5	125	36	PN10	MÉTRICO
1N017	90	2116	90	242	164	52	PN10	MÉTRICO
1N018	110	3050	110	286	188	61	PN10	MÉTRICO
1N019	125	3875	125	325.5	203	69	PN10	MÉTRICO
1N020	140	5405	140	360	224	77	PN10	MÉTRICO
1N021	160	7560	160	409.5	251	86	PN10	MÉTRICO
1N022	200	10400	200	482	297	107	PN10	MÉTRICO



## Product Documents



## Product Certificates

## Company Certificates

