



PVC-U pressure fittings



ITEM 221

| REFERENCE | DESCRIPTION | Net weight | Volumen (m ³) | Gross weight | Unidades lote |
|-----------|--|------------|---------------------------|--------------|---------------|
| 1002230 | RED. TEE 90° PLAIN O./MID.FEMALE TH.OUTLET 25-1/2" | 0,05123 | 0,01553 | 5,962 | 110 |
| 1002231 | RED. TEE 90° PLAIN/THREAD O. 32-1/2" | 0,062723 | 0,02244 | 6,76 | 100 |
| 1002232 | RED. TEE 90° PLAIN O./MID.FEMALE TH.OUTLET 32-3/4" | 0,067173 | 0,02244 | 7,205 | 100 |
| 1002233 | RED. TEE 90° PLAIN O./MID.FEMALE TH.OUTLET 40-1/2" | 0,102689 | 0,03129 | 9,815 | 90 |
| 1002234 | RED. TEE 90° PLAIN O./MID.FEMALE TH.OUTLET 40-3/4" | 0,104338 | 0,03129 | 8,92 | 80 |
| 1002235 | RED. TEE 90° PLAIN O./MID.FEMALE TH.OUTLET 40-1" | 0,112088 | 0,03129 | 9,54 | 80 |
| 1002236 | RED. TEE 90° PLAIN O./MID.FEMALE TH.OUTLET 50-3/4" | 0,155317 | 0,04117 | 10,736 | 65 |
| 1002237 | RED. TEE 90° PLAIN O./MID.FEMALE TH.OUTLET 50-1" | 0,1631 | 0,04117 | 11,24 | 65 |
| 1002238 | RED. TEE 90° PLAIN O./MID.FEMALE TH.O. 50-1 1/4" | 0,183532 | 0,04117 | 12,57 | 65 |
| 1002239 | RED. TEE 90° PLAIN/FEMALE TH. 63-1" | 0,3128 | 0,06347 | 16,425 | 50 |
| 1002240 | RED. TEE 90° PLAIN O./MID.FEMALE TH.O. 63-1 1/4" | 0,321362 | 0,06347 | 16,855 | 50 |
| 1002241 | RED. TEE 90° PLAIN O./MID.FEMALE TH.O. 63-1 1/2" | 0,341453 | 0,06347 | 14,445 | 40 |
| 1002242 | RED. TEE 90° PLAIN O./MID.FEMALE TH.OUTLET 75-1" | 0,482 | 0,03648 | 10,234 | 20 |
| 1002243 | RED. TEE 90° PLAIN O./MID.FEMALE TH.O.75-1 1/4" | 0,462709 | 0,04117 | 10,82 | 22 |
| 1002244 | RED. TEE 90° PLAIN O./MID.FEMALE TH.O.75-1 1/2" | 0,4209 | 0,04117 | 9,298 | 20 |
| 1002245 | RED. TEE 90° PLAIN O./MID.FEMALE TH.OUTLET 75-2" | 0,54398 | 0,04117 | 11,52 | 20 |
| 1002246 | RED. TEE 90° PLAIN O./MID.FEMALE TH.O.90-1 1/4" | 0,8119 | 0,03682 | 10,292 | 12 |
| 1002247 | RED. TEE 90° PLAIN O./MID.FEMALE TH.O.90-1 1/2" | 0,8434 | 0,03682 | 10,67 | 12 |
| 1002248 | RED. TEE 90° PLAIN O./MID.FEMALE TH.OUTLET 90-2" | 0,94 | 0,03682 | 11,9013 | 12 |
| 1002249 | RED. TEE 90° PLAIN O./MID.FEMALE TH.O.90-2 1/2" | 0,855683 | 0,04717 | 10,91 | 12 |
| 1002252 | RED. TEE 90° PLAIN O./MID.FEMALE TH.O.110-2" | 1,49385 | 0,06150 | 15 | 10 |
| 1002253 | RED. TEE 90° PLAIN O./MID.FEMALE TH.O.110-2" | 1,5938 | 0,06150 | 16 | 10 |





PROYECTO 50-172





PVC-U pressure fittings

Central F/T plain 90° reducing tee

ITEM 221

| REFERENCE | DESCRIPTION | Net weight | Volumen (m ³) | contenido.Peso bruto | Unidades lote |
|-----------|-------------|------------|---------------------------|----------------------|---------------|
|-----------|-------------|------------|---------------------------|----------------------|---------------|



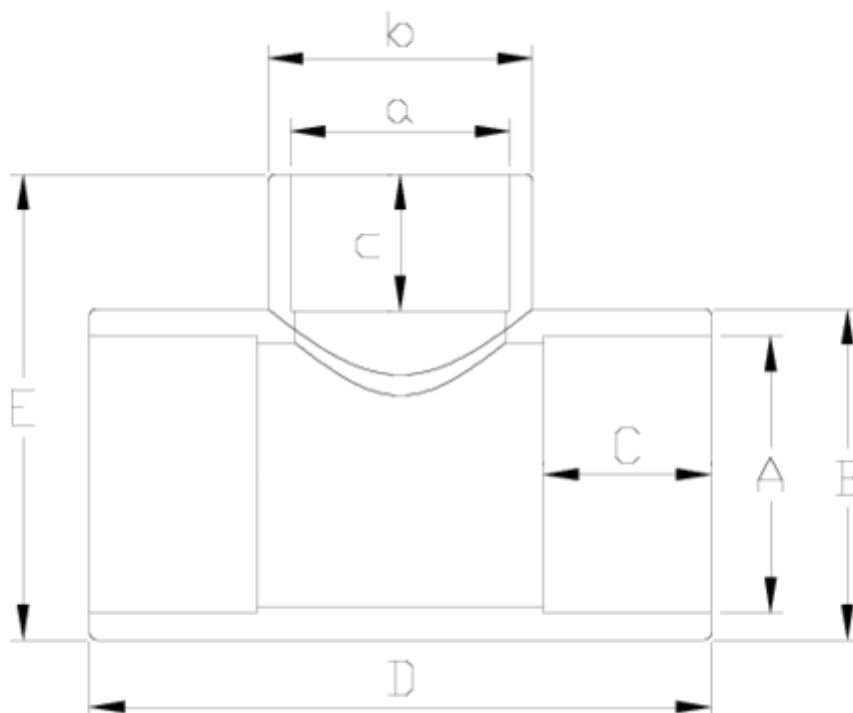

ITEM 221 | Central F/T plain 90° reducing tee

| Código | A-a | Peso (g) | B | C | b | c | D | E | PN | MEDIDA |
|--------|-----------|----------|----|----|----|----|-----|----|------|--------|
| 02230 | 25-1/2" | 37 | 33 | 19 | 27 | 16 | 66 | 47 | PN10 | BSP |
| 02231 | 32-1/2" | 61 | 40 | 22 | 27 | 16 | 79 | 57 | PN10 | BSP |
| 02232 | 32-3/4" | 65 | 40 | 22 | 32 | 19 | 79 | 58 | PN10 | BSP |
| 02233 | 40-1/2" | 87 | 50 | 22 | 27 | 16 | 95 | 66 | PN10 | BSP |
| 02234 | 40-3/4" | 101 | 50 | 26 | 32 | 19 | 95 | 67 | PN10 | BSP |
| 02235 | 40-1" | 105 | 50 | 26 | 40 | 22 | 95 | 70 | PN10 | BSP |
| 02236 | 50-3/4" | 149 | 60 | 26 | 32 | 19 | 114 | 78 | PN10 | BSP |
| 02237 | 50-1" | 152 | 60 | 31 | 40 | 22 | 114 | 80 | PN10 | BSP |
| 02238 | 50-1 1/4" | 161 | 60 | 31 | 50 | 26 | 114 | 84 | PN10 | BSP |
| 02239 | 63-1" | 300 | 76 | 31 | 40 | 22 | 142 | 96 | PN10 | BSP |



ITEM 221 | Central F/T plain 90° reducing tee

| | | | | | | | | | | |
|-------|-----------|------|-----|----|-----|----|-----|-----|------|-----|
| 02240 | 63-1 1/4" | 303 | 76 | 38 | 50 | 26 | 142 | 100 | PN10 | BSP |
| 02241 | 63-1 1/2" | 318 | 76 | 38 | 62 | 31 | 142 | 102 | PN10 | BSP |
| 02242 | 75-1" | 531 | 91 | 38 | 41 | 22 | 171 | 109 | PN10 | BSP |
| 02243 | 75-1 1/4" | 465 | 89 | 45 | 50 | 26 | 167 | 114 | PN10 | BSP |
| 02244 | 75-1 1/2" | 163 | 89 | 44 | 60 | 31 | 167 | 117 | PN10 | BSP |
| 02245 | 75-2" | 574 | 89 | 44 | 76 | 38 | 167 | 126 | PN10 | BSP |
| 02246 | 90-1 1/4" | 832 | 107 | 44 | 50 | 26 | 200 | 132 | PN10 | BSP |
| 02247 | 90-1 1/2" | 951 | 107 | 51 | 60 | 31 | 200 | 140 | PN10 | BSP |
| 02248 | 90-2" | 940 | 107 | 51 | 76 | 38 | 200 | 140 | PN10 | BSP |
| 02249 | 90-2 1/2" | 947 | 107 | 51 | 92 | 44 | 200 | 150 | PN10 | BSP |
| 02252 | 110-2" | 1299 | 130 | 61 | 76 | 38 | 238 | 165 | PN10 | BSP |
| 02253 | 110-3" | 1345 | 130 | 61 | 110 | 39 | 238 | 173 | PN10 | BSP |



Product Documents



Product Certificates



Company Certificates

