



PVC-U pressure fittings

Reinforced plain F/T 45° elbow ITEM 434

REFERENCE	DESCRIPTION	Net weight	Volumen (m ³)	Gross weight	Unidades lote
1002170	45° ELBOW PLAIN/F. THREADED REINF. 20-1/2"	0,020979	0,00473	2,215	100
1002171	45° ELBOW PLAIN/F. THREADED REINF. 25-3/4"	0,039	0,00892	4,04	100
1002172	45° ELBOW PLAIN/F. THREADED 32-1"	0,065	0,01553	6,74	100
1002173	45° ELBOW PLAIN/F. THREADED 40-1 1/4"	0,1026	0,03129	11,853	110
1002174	45° ELBOW PLAIN/F. THREADED 50-1 1/2"	0,149	0,04717	17,15	110
1002175	45° ELBOW PLAIN/F. THREADED 63-2" REINF.	0,252127	0,06347	14,697	55
1002176	45° ELBOW PLAIN/F. THREADED 75-2 1/2"	0,393	0,04117	13,6569	33
1002177	45° ELBOW PLAIN/F. THREADED 90-3"	0,683	0,04117	11,6159	16



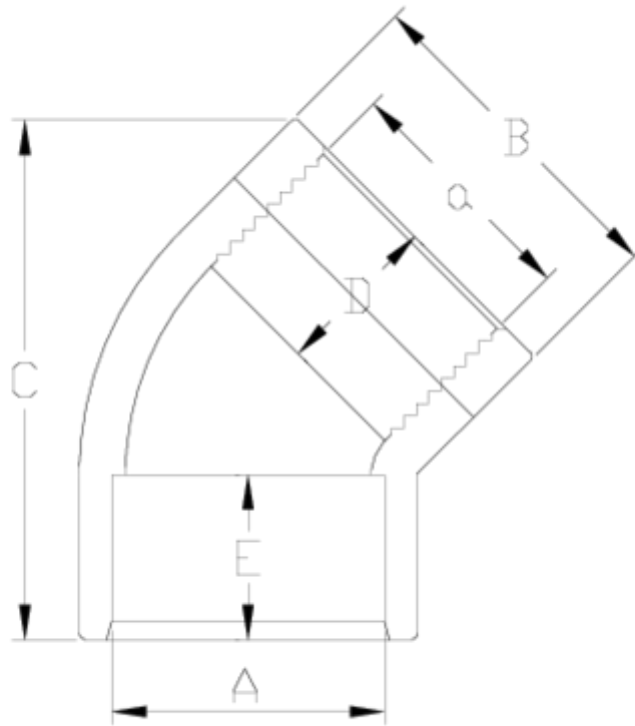

ITEM 434 | Reinforced plain F/T 45° elbow

Código	A-a	Peso (g)	B	C	D	E	PN	ROSCA
02170	20-1/2"	28	27	48	16	16	PN10	BSP
02171	25-3/4"	39	33	53	19	17	PN10	BSP
02172	32-1"	65	41	63	22	21	PN10	BSP
02173	40-1 1/4"	89	50	80	26	23	PN10	BSP
02174	50-1 1/2"	149	61	95	31	24	PN10	BSP
02175	63-2"	259	75	125	38	28	PN10	BSP
02176	75-2 1/2"	393	89	140	45	32	PN10	BSP
02177	90-3"	683	107	162	51	35	PN10	BSP



Product Documents



Product Certificates

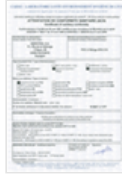

Company Certificates

