



## PP Compression Fittings

# TE FITTING VÁLVULA COMPACT R-H

### ITEM 899

| REFERENCIA | DESCRIPCIÓN                                 | Peso neto | Volumen (m <sup>3</sup> ) | Peso bruto | Unidades lote |
|------------|---|-----------|---------------------------|------------|---------------|
| 112E286    | TE S/FITTING COMP R/H 32-20-1/2"-32 GRIS    | 0         | 0,02243                   | 0          | 8             |
| 112E287    | TE S/FITTING COMP R/H 32-25-3/4"-32 GRIS    | 0         | 0,02243                   | 0          | 8             |
| 112E292    | TE S/FITTING COMPACT R/H 63-25-3/4"-63 GRIS | 1,216     | 0,06347                   | 10,3931    | 8             |
| 112E293    | TE S/FITTING COMPACT R/H 63-32-1"-63 GRIS   | 1,316     | 0,06347                   | 11,179     | 8             |



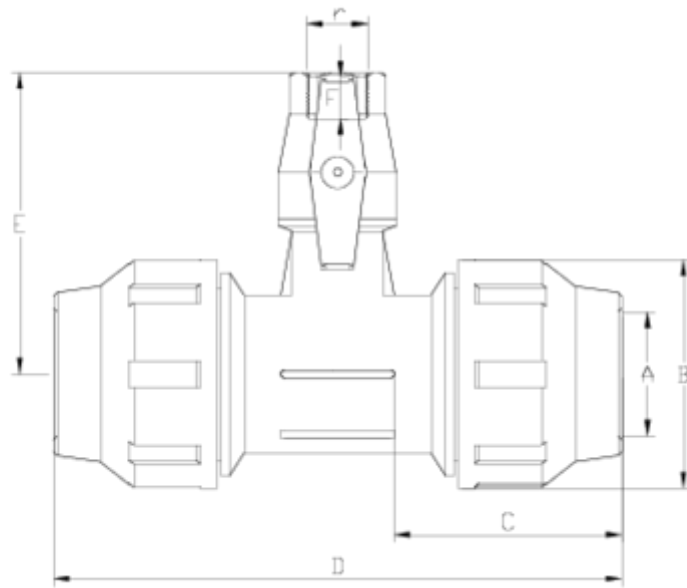

## ITEM 899 | TE FITTING VÁLVULA COMPACT R-H

| Code   | A - r - A    | Weight (g) | B   | C   | D   | E   | F  | PN   | TIPO ROSCA |
|--------|--------------|------------|-----|-----|-----|-----|----|------|------------|
| 12E286 | 32 - 1/2"-32 | 320        | 64  | 70  | 170 | 114 | 17 | PN16 | BSP        |
| 12E287 | 32 - 3/4"-32 | 345        | 64  | 70  | 170 | 121 | 20 | PN16 | BSP        |
| 12E292 | 63 - 3/4"-63 | 1183       | 109 | 113 | 274 | 141 | 20 | PN16 | BSP        |
| 12E293 | 63-1"-63     | 1266       | 109 | 113 | 274 | 149 | 23 | PN16 | BSP        |



## Documentación de Producto



## Certificados de Producto

## Certificados de Empresa

