



Colliers de prise

Collier de prise double 6 vis ITEM 131

| REFERENCE | DESCRIPTION | Poids net | Volume (m ³) | Poids brut | Unités par lot |
|-----------|--------------------------------|-----------|--------------------------|------------|----------------|
| 1003129 | COLLARIN TOMA DOBLE 160-1/2" | 1.1656 | 0.061499 | 19.6296 | 16 |
| 1003133 | COLLARIN TOMA DOBLE 160-3/4" | 1.1556 | 0.061499 | 19.4698 | 16 |
| 1003137 | COLLARIN TOMA DOBLE 140-1/2" | 1.0545 | 0.061499 | 17.852 | 16 |
| 1003141 | COLLARIN TOMA DOBLE 140-3/4" | 1.059 | 0.061499 | 17.932 | 16 |
| 1003239 | COLLARIN TOMA DOBLE 140-1" | 1.081 | 0.061499 | 18.26 | 16 |
| 1003240 | COLLARIN TOMA DOBLE 140-1 1/4" | 1.095 | 0.061499 | 18.484 | 16 |
| 1003241 | COLLARIN TOMA DOBLE 140-1 1/2" | 1.069 | 0.061499 | 18.068 | 16 |
| 1003242 | COLLARIN TOMA DOBLE 140-2" | 1.097 | 0.061499 | 18.516 | 16 |
| 1003243 | COLLARIN TOMA DOBLE 140-2 1/2" | 1.197 | 0.061499 | 20.116 | 16 |
| 1003244 | COLLARIN TOMA DOBLE 140-3" | 1.095 | 0.061499 | 18.52 | 16 |
| 1003245 | COLLARIN TOMA DOBLE 160-1" | 1.195 | 0.061499 | 20.114 | 16 |
| 1003246 | COLLARIN TOMA DOBLE 160-1 1/4" | 1.201 | 0.061499 | 20.18 | 16 |
| 1003247 | COLLARIN TOMA DOBLE 160-1 1/2" | 1.179031 | 0.061499 | 19.825 | 16 |
| 1003248 | COLLARIN TOMA DOBLE 160-2" | 1.195281 | 0.061499 | 20.085 | 16 |
| 1003249 | COLLARIN TOMA DOBLE 160-2 1/2" | 1.325 | 0.061499 | 19.514 | 12 |
| 1003250 | COLLARIN TOMA DOBLE 160-3" | 1.235 | 0.088425 | 20.724 | 16 |
| 1003251 | COLLARIN TOMA DOBLE 200-1 1/4" | 2.032 | 0.061499 | 17.22 | 8 |
| 1003252 | COLLARIN TOMA DOBLE 200-1 1/2" | 2.018 | 0.061499 | 17.108 | 8 |
| 1003253 | COLLARIN TOMA DOBLE 200-2" | 2.05 | 0.061499 | 17.364 | 8 |
| 1003254 | COLLARIN TOMA DOBLE 200-2 1/2" | 2.152 | 0.061499 | 18.18 | 8 |
| 1003255 | COLLARIN TOMA DOBLE 200-3" | 2.05 | 0.061499 | 17.364 | 8 |
| 1003256 | COLLARIN TOMA DOBLE 200-4" | 2.17 | 0.061499 | 18.324 | 6 |
| 1003483 | COLLARIN TOMA DOBLE 180-1" | 1.6145 | 0.031294 | 13.4129 | 8 |





Colliers de prise

Collier de prise double 6 vis ITEM 131

| REFERENCE | DESCRIPTION | Poids net | Volume (m ³) | contenido.Peso bruto | Units par lot |
|-----------|---------------------------------|-----------|--------------------------|----------------------|---------------|
| 1003484 | COLLARIN TOMA DOBLE 180-1 1/4" | 1.6145 | 0.031294 | 13.4129 | 8 |
| 1003485 | COLLARIN TOMA DOBLE 180-1 1/2" | 1.6145 | 0.031294 | 13.4129 | 8 |
| 1003486 | COLLARIN TOMA DOBLE 180-2" | 1.6145 | 0.031294 | 13.4129 | 8 |
| 1003487 | COLLARIN TOMA DOBLE 180- 2 1/2" | 1.6145 | 0.031294 | 13.4129 | 8 |
| 1003488 | COLLARIN TOMA DOBLE 180-3" | 1.6145 | 0.031294 | 13.4129 | 8 |



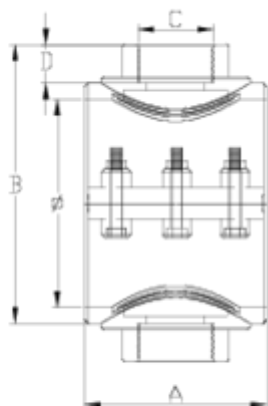

ITEM 131 | Collier de prise double 6 vis

| Código | f tubo - C | Peso (g) | A | B | D | PN | TIPO ROSCA |
|--------|--------------|----------|-----|-----|----|------|------------|
| 03135 | 140 - 1/2" | 1081.6 | 134 | 185 | 16 | PN10 | BSP |
| 03139 | 140 - 3/4" | 1086.8 | 134 | 185 | 17 | PN10 | BSP |
| 03038 | 140 - 1" | 1034.8 | 134 | 190 | 21 | PN10 | BSP |
| 03039 | 140 - 1 1/4" | 1040 | 134 | 195 | 23 | PN10 | BSP |
| 03040 | 140 - 1 1/2" | 1034.8 | 134 | 195 | 31 | PN10 | BSP |
| 03041 | 140 - 2" | 1045.2 | 134 | 203 | 38 | PN10 | BSP |
| 03109 | 140 - 2 1/2" | 1097.2 | 134 | 203 | 44 | PN10 | BSP |
| 03042 | 140 - 3" | 1071.2 | 134 | 112 | 53 | PN10 | BSP |
| 03127 | 160 - 1/2" | 1133.6 | 136 | 210 | 16 | PN10 | BSP |
| 03131 | 160 - 3/4" | 1138.8 | 136 | 210 | 17 | PN10 | BSP |





ITEM 131 | Collier de prise double 6 vis

| | | | | | | | |
|-------|--------------|---------|-----|-----|----|-------------|-----|
| 03043 | 160 - 1" | 1164.8 | 136 | 210 | 21 | PN10 | BSP |
| 03044 | 160 - 1 1/4" | 1170 | 136 | 210 | 23 | PN10 | BSP |
| 03045 | 160 - 1 1/2" | 1201.2 | 136 | 210 | 31 | PN10 | BSP |
| 03046 | 160 - 2" | 1211.6 | 136 | 218 | 38 | PN10 | BSP |
| 03111 | 160 - 2 1/2" | 1263.6 | 136 | 218 | 44 | PN10 | BSP |
| 03047 | 160 - 3" | 1232.4 | 136 | 218 | 53 | PN10 | BSP |
| 03483 | 180 - 1" | 1418 | 152 | 234 | 21 | PN10 | BSP |
| 03484 | 180 - 1 1/4" | 1428 | 152 | 234 | 23 | PN10 | BSP |
| 03485 | 180 - 1 1/2" | 1418 | 152 | 234 | 31 | PN10 | BSP |
| 03486 | 180 - 2" | 1438 | 152 | 244 | 38 | PN10 | BSP |
| 03487 | 180 - 2 1/2" | 1500 | 152 | 244 | 44 | PN10 | BSP |
| 03488 | 180-3" | 1460 | 152 | 260 | 53 | PN10 | BSP |
| 03048 | 200 - 1 1/4" | 2043.6 | 173 | 244 | 23 | PN6 | BSP |
| 03049 | 200 - 1 1/2" | 2036.32 | 173 | 250 | 31 | PN6 | BSP |
| 03050 | 200 - 2" | 2052.96 | 173 | 254 | 38 | PN6 | BSP |
| 03113 | 200 - 2 1/2" | 2189.2 | 173 | 254 | 44 | PN6 | BSP |
| 03051 | 200 - 3" | 2052.96 | 173 | 266 | 53 | PN6 | BSP |
| 03052 | 200 - 4" | 2115.36 | 173 | 266 | 61 | PN6 | BSP |





Documentation Produit

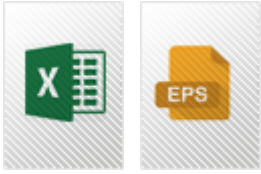

Certifications de produits

Certificats d'entreprise

