



## PVC-U pressure fittings

# 3-way distributor female threaded

### ITEM 532

REFERENCE	DESCRIPTION	Net weight	Volumen (m <sup>3</sup> )	Gross weight	Unidades lote
1002353	MANIFOLD FEMALE THR. 32-1"	0,41403	0,01553	4,585	10
1002355	PVC FEM. THREAD MANIFOLD 63-1 1/2" - GREY	1,736675	0,02244	7,51	4
1002366	PVC FEM. THREAD MANIFOLD 63-2" - GREY	0,744175	0,04460	3,54	4



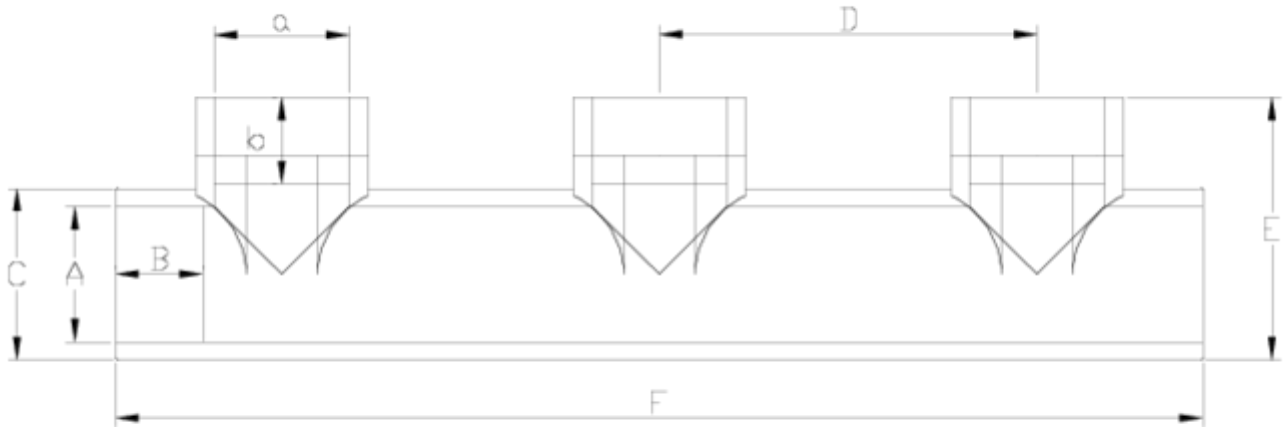

## ITEM 532 | 3-way distributor female threaded

Código	A-a	Peso (g)	b	B	C	D	E	F	PN	ROSCA
02353	1" -1"	420	22	22	40	115	61	308	PN10	BSP
02355	2"-1 1/2"	1103	21	38	75	165	115	460	PN10	BSP
02366	2"-2"	1201	26	38	75	165	115	460	PN10	BSP



## Product Documents



## Product Certificates



## Company Certificates

