



## PVC-U pressure fittings

# Adaptor union PVC-U to brass m/t

## ITEM 979

REFERENCE	DESCRIPTION	Net weight	Volumen (m <sup>3</sup> )	Gross weight	Unidades lote
1002989		0,1297	0,00472	0,7681	5
1002990	ADAPTOR UNION PVC-U TO BRASS M/T 20-25 1/2"	0,07178	0,00472	0,476	5
1002993		0,216	0,00472	1,2018	5
1002991	ADAPTOR UNION PVC-U TO BRASS M/T 25-32 3/4"	0,10658	0,00472	0,65	5
1002994		0,206	0,00472	1,1518	5
1002992	ADAPTOR UNION PVC-U TO BRASS M/T 32-40 1"	0,19258	0,00472	1,08	5



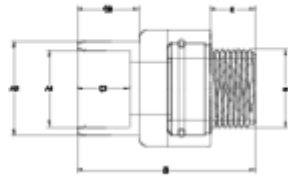

## ITEM 979 | Adaptor union PVC-U to brass m/t

Código	A1-A2 x a	Peso (g)	B	C1	C2	c	PN	ROSCA
02989	16-20x1/2"	112	56	16	19	15	PN10	BSP
02990	20-25x1/2"	132	56	17	19	15	PN10	BSP
02993	20-25x3/4"	217	63	17	19	17	PN10	BSP
02991	25-32x3/4"	237	63	19	22	17	PN10	BSP
02994	25-32x1"	298	73	19	22	19	PN10	BSP
02992	32-40x1"	318	76	22	26	19	PN10	BSP



## Product Documents



## Product Certificates



## Company Certificates

