



Spare parts

BIDIRECTIONAL BALL VALVE MAIN BODY FPM ITEM 609

REFERENCE	DESCRIPTION	Net weight	Volumen (m ³)	Gross weight	Unidades lote
111D760	FPM, BIDIRECTION BALL VALVE BODY 20	0,1144	0,02244	3,921	30
111D761	FPM, BIDIRECTION BALL VALVE BODY 25	0,1126	0,02244	2,582	20
111D762	FPM, BIDIRECTION BALL VALVE BODY 32	0,265	0,01553	8,73	30
111D763	FPM, BIDIRECTION BALL VALVE BODY 40	0,3467	0,04117	1,234	14
111D764	FPM, BIDIRECTION BALL VALVE BODY 50	0,425	0,04880	8,867	15
111D765	FPM, BIDIRECTION BALL VALVE BODY 63	0,858917	0,04880	10,967	12
111D766	FPM, BIDIRECTION BALL VALVE BODY 75	1,495	0,03129	3,563	2
111D767	CUERPO V.E. BIDIRECCIONAL 90 FPM	2,4186	0,03129	5,3249	2



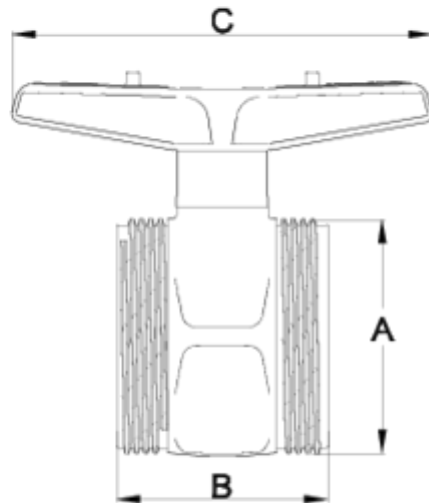

ITEM 609 | BIDIRECTIONAL BALL VALVE MAIN BODY FPM

CÓDIGO	f	PESO (g)	DN	A	B	C	PN	MEDIDA
11D760	20	83	15	42	44	73	PN16	MÉTRICO
11D761	25	101	20	47	49	73	PN16	MÉTRICO
11D762	32	199	25	57	66	110	PN16	MÉTRICO
11D763	40	324	32	71	71	120	PN16	MÉTRICO
11D764	50	422	40	83	75	120	PN16	MÉTRICO
11D765	63	700	50	98	89	178	PN16	MÉTRICO
11D766	75	1495	65	127	119	260	PN10	MÉTRICO



Pol. Ind. Plá Vallonga,
c/ Agua, 28
03006 ALICANTE (España)



+34 965 11 42 82



+34 965 11 48 62



tecnicocomercial@hidroten.es



Technical &
Commercial Service
+ 34 966 105 888



www.hidroten.es



Product Documents



Product Certificates

Company Certificates

