



Net air release valve

Brass-base triple effect (D2) - PA ITEM 443

REFERENCE	DESCRIPTION	Net weight	Volumen (m ³)	Gross weight	Unidades lote
1017806	NET® AIR VALVE 2" PA BRASS TRIPLE EFFECT	2,06805	0,02244	12,896	6



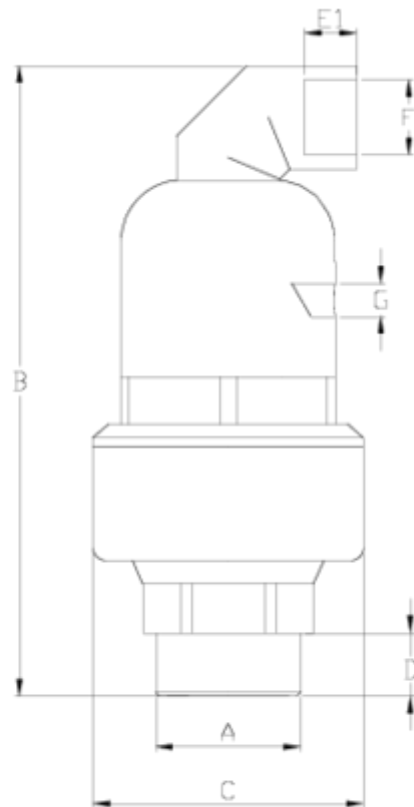

ITEM 443 | Brass-base triple effect (D2) - PA

Código	f A	Peso (g)	B	C	D	E	F	G	Material	PN	TIPO ROSCA
17206	2"	1964	260	112	30	21	1"	3/8"	PPFV	PN16	BSP
17806	2"	2003	260	112	30	21	1"	3/8"	PA	PN25	BSP



Product Documents



Product Certificates

Company Certificates

