



## Brass pressure fittings

# Straight coupling, male threaded

## ITEM 150



REFERENCE	DESCRIPTION	Net weight	Volumen (m <sup>3</sup> )	Gross weight	Unidades lote
1020037	BRASS STRAIGHT COUPL.,M.THR. 20-1/2"	0,0788	0,00473	4,063	50
1020038	BRASS STRAIGHT COUPL.,M.THR. 25-3/4"	0,1246	0,00473	5,1	40
1020039	BRASS STRAIGHT COUPL.,M.THR. 32-1"	0,2041	0,00892	8,35	40
1020040	BRASS STRAIGHT COUPL.,M.THR. 40-1 1/4"	0,31233	0,01553	14,38155	45
1020041	BRASS STRAIGHT COUPL.,M.THR. 50-1 1/2"	0,494089	0,00892	9,081	18
1020042	BRASS STRAIGHT COUPL.,M.THR. 63-2"	0,8158	0,01553	13,38	16
1020043	BRASS STRAIGHT COUPL.,M.THR. 75-2 1/2"	1,679	0,00892	10,234	6
1020044	BRASS STRAIGHT COUPL.,M.THR. 90-3"	2,1064	0,01553	12,965	6
1020045	BRASS STRAIGHT COUPL.,M.THR. 110-4"	3,1763	0,00892	6,54	2

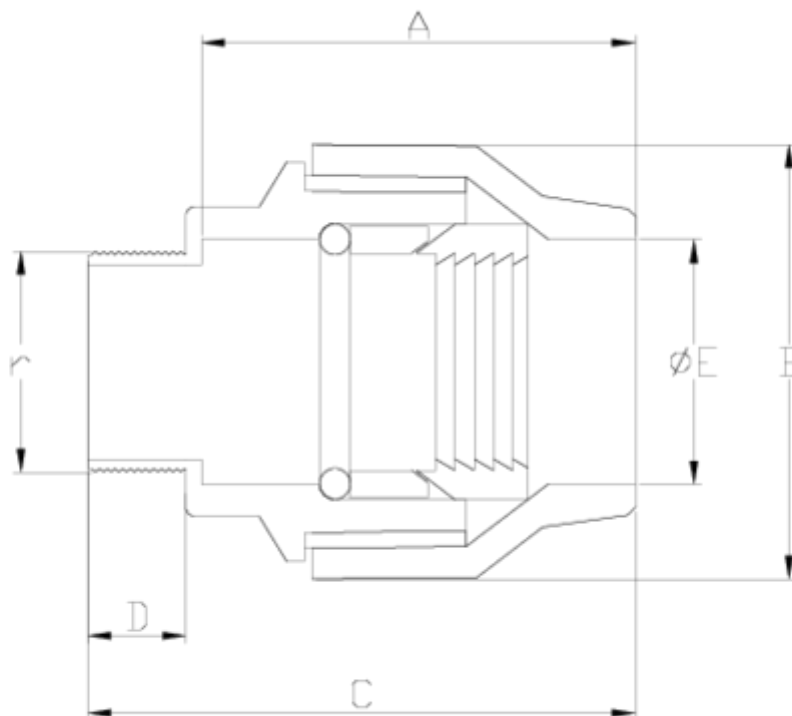

## ITEM 150 | Straight coupling, male threaded

Código	f tubo-R	Peso (g)	A	B	C	D	E	r	PN	TIPO ROSCA
20037	20-1/2"	90	32.5	35	44.5	8	21	1/2"	PN25	BSP
20038	25-3/4"	143	36	41.5	50	9.5	26	3/4"	PN25	BSP
20039	32-1"	194	44.5	49.5	61.5	12	33	1"	PN25	BSP
20040	40-1 1/4"	346	50.5	61	68	13.5	41.8	1 1/4"	PN25	BSP
20041	50-1 1/2"	522	49.8	74.3	67.6	11	51.2	1 1/2"	PN25	BSP
20042	63-2"	822	65	91.2	87	14	64	2"	PN25	BSP
20043	75-2 1/2"	1420	135	88	99.8				PN25	BSP
20044	90-3"	2163	154	104	111.4				PN25	BSP
20045	110-4"	3230	179	129	145				PN25	BSP



## Product Documents



## Product Certificates

## Company Certificates

