



## Clamp saddles

# Double clamp saddle 6 screws

## ITEM 131

REFERENCE	DESCRIPTION	Net weight	Volumen (m <sup>3</sup> )	Gross weight	Unidades lote
1003129	PP DOUBLE CLAMP SADDLE 160-1/2"	1,1656	0,06150	19,6296	16
1003133	PP DOUBLE CLAMP SADDLE 160-3/4"	1,1556	0,06150	19,4698	16
1003137	PP DOUBLE CLAMP SADDLE 140-1/2"	1,0545	0,06150	17,852	16
1003141	PP DOUBLE CLAMP SADDLE 140-3/4"	1,059	0,06150	17,932	16
1003239	PP DOUBLE CLAMP SADDLE 140-1"	1,042344	0,06150	17,598	16
1003240	PP DOUBLE CLAMP SADDLE 140-1 1/4"	1,095	0,06150	18,484	16
1003241	PP DOUBLE CLAMP SADDLE 140-1 1/2"	1,102594	0,06150	18,562	16
1003242	PP DOUBLE CLAMP SADDLE 140-2"	1,097	0,06150	18,516	16
1003243	PP DOUBLE CLAMP SADDLE 140-2 1/2"	1,197	0,06150	20,116	16
1003244	PP DOUBLE CLAMP SADDLE 140-3"	1,095	0,06150	18,52	16
1003245	PP DOUBLE CLAMP SADDLE 160-1"	1,195	0,06150	20,114	16
1003246	PP DOUBLE CLAMP SADDLE 160-1 1/4"	1,201	0,06150	20,18	16
1003247	PP DOUBLE CLAMP SADDLE 160-1 1/2"	1,179031	0,06150	19,825	16
1003248	PP DOUBLE CLAMP SADDLE 160-2"	1,195281	0,06150	20,085	16
1003249	PP DOUBLE CLAMP SADDLE 160-2 1/2"	1,325	0,06150	19,514	12
1003250	PP DOUBLE CLAMP SADDLE 160-3"	1,235	0,08843	20,724	16
1003251	PP DOUBLE CLAMP SADDLE 200-1 1/4"	2,032	0,06150	17,22	8
1003252	PP DOUBLE CLAMP SADDLE 200-1 1/2"	2,018	0,06150	17,108	8
1003253	PP DOUBLE CLAMP SADDLE 200-2"	2,05	0,06150	17,364	8
1003254	PP DOUBLECLAMP SADDLE 200-2 1/2"	2,152	0,06150	18,18	8
1003255	PP DOUBLE CLAMP SADDLE 200-3"	2,05	0,06150	17,364	8
1003256	PP DOUBLE CLAMP SADDLE 200-4"	2,17	0,06150	18,324	6
1003483	PP DOUBLE CLAMP SADDLE 180-1"	1,6145	0,03129	13,4129	8





## Clamp saddles

# Double clamp saddle 6 screws

## ITEM 131

REFERENCE	DESCRIPTION	Net weight	Volumen (m <sup>3</sup> )	contenido.Peso bruto	Unidades lote
1003484	PP DOUBLE CLAMP SADDLE 180-1 1/4"	1,6145	0,03129	13,4129	8
1003485	PP DOUBLE CLAMP SADDLE 180-1 1/2"	1,6145	0,03129	13,4129	8
1003486	PP DOUBLE CLAMP SADDLE 180-2"	1,6145	0,03129	13,4129	8
1003487	PP DOUBLE CLAMP SADDLE 180-2 1/2"	1,6145	0,03129	13,4129	8
1003488	PP DOUBLE CLAMP SADDLE 180-3"	1,6145	0,03129	13,4129	8



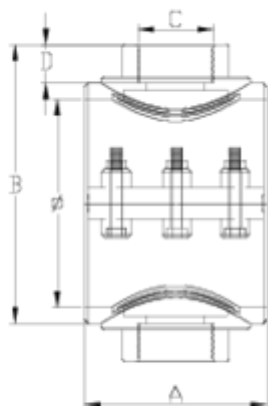

## ITEM 131 | Double clamp saddle 6 screws

Código	f tubo - C	Peso (g)	A	B	D	PN	TIPO ROSCA
03135	140 - 1/2"	1081.6	134	185	16	PN10	BSP
03139	140 - 3/4"	1086.8	134	185	17	PN10	BSP
03038	140 - 1"	1034.8	134	190	21	PN10	BSP
03039	140 - 1 1/4"	1040	134	195	23	PN10	BSP
03040	140 - 1 1/2"	1034.8	134	195	31	PN10	BSP
03041	140 - 2"	1045.2	134	203	38	PN10	BSP
03109	140 - 2 1/2"	1097.2	134	203	44	PN10	BSP
03042	140 - 3"	1071.2	134	112	53	PN10	BSP
03127	160 - 1/2"	1133.6	136	210	16	PN10	BSP
03131	160 - 3/4"	1138.8	136	210	17	PN10	BSP



## ITEM 131 | Double clamp saddle 6 screws

03043	160 - 1"	1164.8	136	210	21	<b>PN10</b>	BSP
03044	160 - 1 1/4"	1170	136	210	23	<b>PN10</b>	BSP
03045	160 - 1 1/2"	1201.2	136	210	31	<b>PN10</b>	BSP
03046	160 - 2"	1211.6	136	218	38	<b>PN10</b>	BSP
03111	160 - 2 1/2"	1263.6	136	218	44	<b>PN10</b>	BSP
03047	160 - 3"	1232.4	136	218	53	<b>PN10</b>	BSP
03483	180 - 1"	1418	152	234	21	<b>PN10</b>	BSP
03484	180 - 1 1/4"	1428	152	234	23	<b>PN10</b>	BSP
03485	180 - 1 1/2"	1418	152	234	31	<b>PN10</b>	BSP
03486	180 - 2"	1438	152	244	38	<b>PN10</b>	BSP
03487	180 - 2 1/2"	1500	152	244	44	<b>PN10</b>	BSP
03488	180-3"	1460	152	260	53	<b>PN10</b>	BSP
03048	200 - 1 1/4"	2043.6	173	244	23	<b>PN6</b>	BSP
03049	200 - 1 1/2"	2036.32	173	250	31	<b>PN6</b>	BSP
03050	200 - 2"	2052.96	173	254	38	<b>PN6</b>	BSP
03113	200 - 2 1/2"	2189.2	173	254	44	<b>PN6</b>	BSP
03051	200 - 3"	2052.96	173	266	53	<b>PN6</b>	BSP
03052	200 - 4"	2115.36	173	266	61	<b>PN6</b>	BSP



## Product Documents



## Product Certificates

## Company Certificates

