



## 'Compact' ball valves

# Fitting female threaded outlet

# PTFE

## ITEM 716

REFERENCE	DESCRIPTION	Net weight	Volumen (m <sup>3</sup> )	Gross weight	Unidades lote
111C060	GFPP COMP.B.VALV. FITTING/FEMALE THR.20-1/2"	0,1552	0,01553	3,431	20
111C061	GFPP COMP.B.VALV. FITTING/FEMALE THR.25-3/4"	0,202	0,01553	4,37	20
111C062	GFPP COMP.B.VALV. FITTING/FEMALE THR.32-1"	0,294987	0,02244	4,95	15



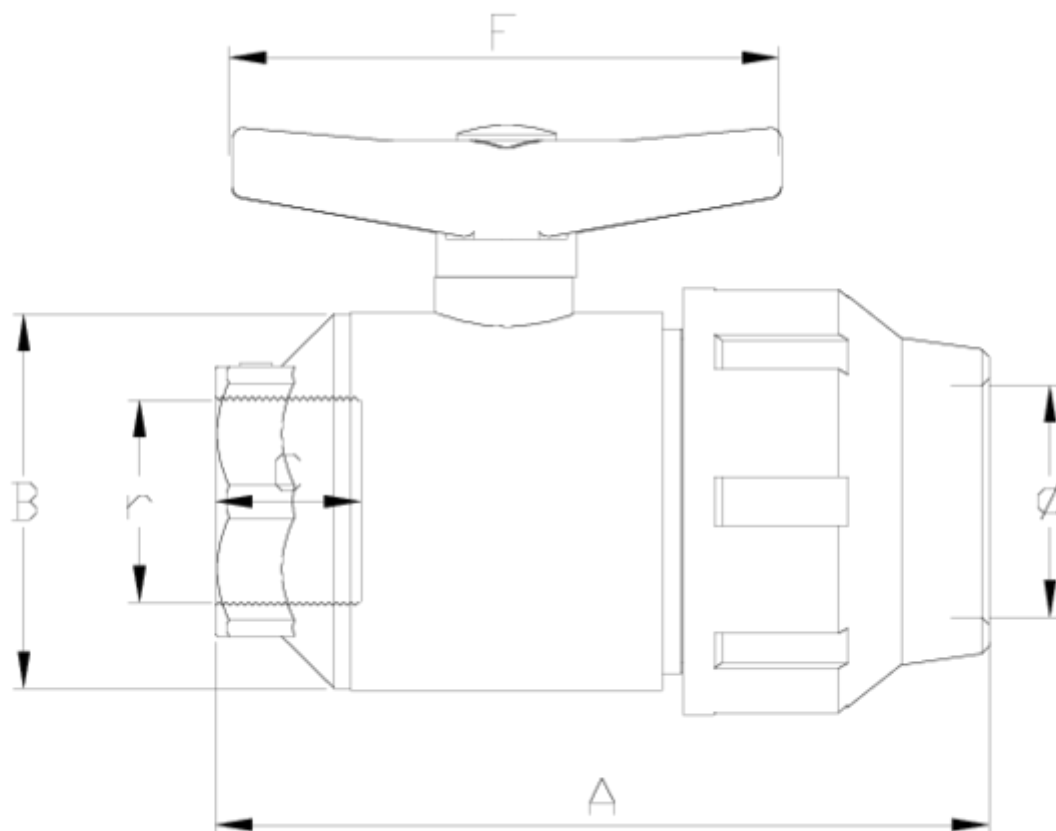

## ITEM 716 | Fitting female threaded outlet PTFE

CÓDIGO	d-r	DN	PESO (g)	A	B	C	F	PN	TIPO ROSCA
11C060	20-1/2"	15	155	121	48	17	80	PN10	BSP
11C061	25-3/4"	20	202	134	53	21	80	PN10	BSP
11C062	32-1"	25	295	152	59	23	101	PN10	BSP



## Product Documents



## Product Certificates

## Company Certificates

