



Net air release valve

double effect, brass base (C2)

GRPP

ITEM 315

| REFERENCE | DESCRIPTION | Net weight | Volumen (m ³) | Gross weight | Unidades lote |
|-----------|--|------------|---------------------------|--------------|---------------|
| 1017306 | NET® AIR VALVE 2" PP BRASS DOUBLE EFFECT | 1,88205 | 0,02244 | 11,78 | 6 |



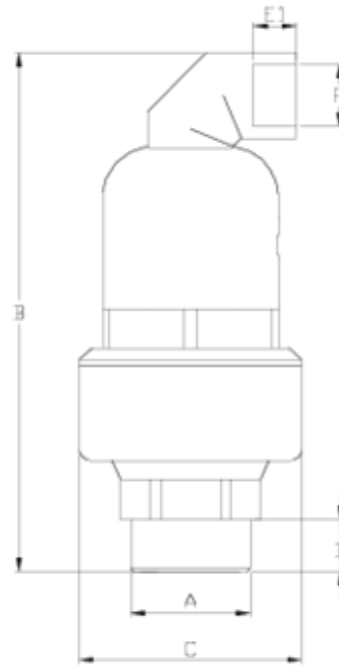

ITEM 315 | double effect, brass base (C2) GRPP

| Código | f A | Peso (g) | B | C | D | E | F | Material | PN | TIPO ROSCA |
|--------|-----|----------|-----|-----|----|----|----|----------|------|------------|
| 17306 | 2" | 1944 | 260 | 112 | 30 | 21 | 1" | PPFV | PN16 | BSP |
| 17706 | 2" | 1984 | 260 | 112 | 30 | 21 | 1" | PA | PN25 | BSP |



Product Documents



Product Certificates

Company Certificates

