



'Compact' ball valves

Male threaded elbow - FPM seal ITEM 887



| REFERENCE | DESCRIPTION | Net weight | Volumen (m ³) | Gross weight | Unidades lote |
|-----------|---------------------------------|------------|---------------------------|--------------|---------------|
| 111C180 | V.COMP.ACOD.RM-RM 1/2"-1/2" FPM | 0,133 | 0,00892 | 2,833 | 20 |
| 111C181 | V.COMP.ACOD.RM-RM 1/2"-3/4" FPM | 0,131 | 0,00892 | 2,817 | 20 |
| 111C182 | V.COMP.ACOD.RM-RM 3/4"-3/4" FPM | 0,177 | 0,00892 | 2,748 | 15 |
| 111C183 | V.COMP.ACOD.RM-RM 3/4"-1" FPM | 0,173 | 0,00892 | 2,724 | 15 |

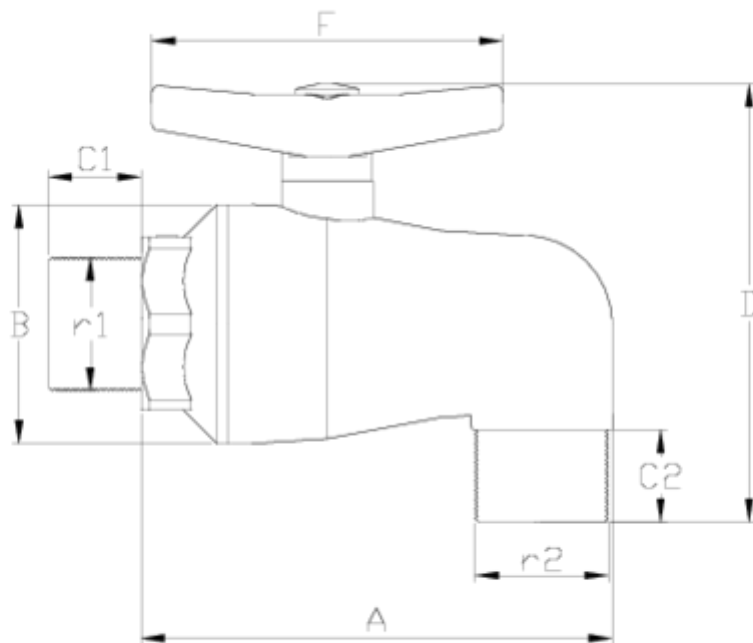

ITEM 887 | Male threaded elbow - FPM seal

| CÓDIGO | r1-r2 | DN | PESO (g) | A | B | C1 | C2 | D | F | PN | TIPO ROSCA |
|--------|-----------|----|----------|-----|----|----|----|-----|----|------|------------|
| 11C180 | 1/2"-1/2" | 15 | 133 | 111 | 48 | 14 | 14 | 104 | 80 | PN10 | BSP |
| 11C181 | 1/2"-3/4" | 15 | 131 | 111 | 48 | 14 | 17 | 106 | 80 | PN10 | BSP |
| 11C182 | 3/4"-3/4" | 20 | 177 | 120 | 53 | 17 | 17 | 109 | 80 | PN10 | BSP |
| 11C183 | 3/4"-1" | 20 | 173 | 120 | 53 | 17 | 19 | 112 | 80 | PN10 | BSP |



Product Documents



Product Certificates

Company Certificates

