



PVC check valves (with spring)

Thermofusion outlet - Foot - EPDM seal ITEM 510



REFERENCE	DESCRIPTION	Net weight	Volumen (m ³)	Gross weight	Unidades lote
1016131	PVC FOOT CHECK V. (W/SPR), THERMO O.20	0,129	0,02244	5,7	40
1016132	PVC FOOT CHECK V. (W/SPR), THERMO O.25	0,174	0,03129	6,8	40
1016133	PVC FOOT CHECK V. (W/SPR), THERMO O.32	0,299	0,03129	8,45	30
1016134	PVC FOOT CHECK V. (W/SPR), THERMO O.40	0,44	0,03129	7,312	16
1016135	PVC FOOT CHECK V. (W/SPR), THERMO O.50	0,642	0,03682	9,803	15
1016136	PVC FOOT CHECK V. (W/SPR), THERMO O.63	1,05	0,04836	12,43	10
1016137	PVC FOOT CHECK V. (W/SPR), THERMO O.75	2,181	0,04717	11,76	5
1016138	PVC FOOT CHECK V. (W/SPR), THERMO O.90	3,4962	0,03129	7,536	2

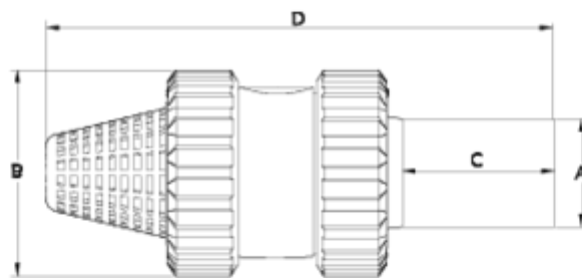

ITEM 510 | Thermofusion outlet - Foot - EPDM seal

Código EPDM	A	Peso	B	C	D	PN	MEDIDA
16131	20	110	52	62	170	PN16	MÉTRICO
16132	25	140	59	62	178	PN16	MÉTRICO
16133	32	233	69	46	195	PN16	MÉTRICO
16134	40	378	85	64	226	PN16	MÉTRICO
16135	50	524	99	79	253	PN16	MÉTRICO
16136	63	862	116	89	270	PN16	MÉTRICO
16137	75	2279	150	91	341	PN10	MÉTRICO
16138	90	3496	178	100	400	PN10	MÉTRICO





Product Documents



Product Certificates

Company Certificates

