



## 'Semi compact' ball valves

# M. thread-solvent s. outlet

## ITEM 729

REFERENCE	DESCRIPTION	Net weight	Volumen (m <sup>3</sup> )	contenido.peso bruto	Unidades lote
111S025	V??LVULA SEMICOMPACTA S/ENC-R/M 50-1 1/2"	0.737	0.03129	11.63	15
111S026	V??LVULA SEMICOMPACTA S/ENC-R/M 63-2"	1.076	0.03682	10.76	10



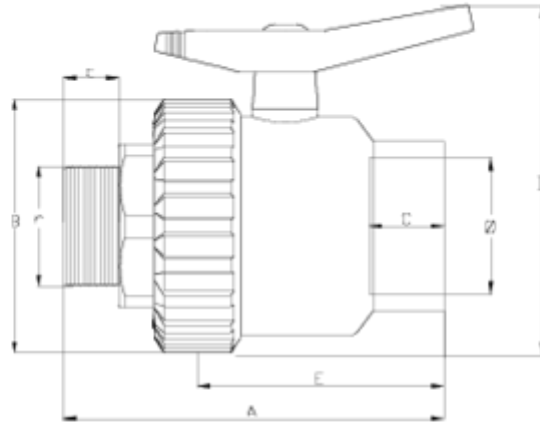

## ITEM 729 | M. thread-solvent s. outlet

C??DIGO PE	f-r	DN	PESO (g)	A	B	C	c	D	E	PN	TIPO ROSCA
11S025	50-1 1/2"	40	695	170	99	31	22	138	109	PN10	BSP
11S026	63-2"	50	1080	193	116	38	25	172	124	PN10	BSP



## Product Documents

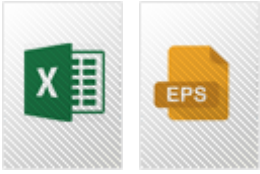

## Product Certificates

## Company Certificates

