



PVC-U pressure fittings

Union, plain socket - female thread socket, female threaded outlet

ITEM 030



| REFERENCE | DESCRIPTION | Net weight | Volumen (m ³) | Gross weight | Unidades lote |
|-----------|---|------------|---------------------------|--------------|---------------|
| 1002513 | UNION, MALE THREAD.- FEMALE THREAD. 1"-1" | 0,1141 | 0,00891 | 2,925 | 24 |
| 1002514 | UNION, MALE THREAD.- FEMALE THREAD. 2"-2" | 0,4295 | 0,03129 | 10,88 | 24 |
| 1002515 | UNION, M. THREAD S./F. THREAD 1 1/2"-1 1/2" | 0,2514 | 0,04717 | 15,725 | 60 |
| 1002519 | UNION, M. THREAD S./F. THREAD 2"-1 1/2" | 0,411 | 0,03129 | 10,437 | 24 |



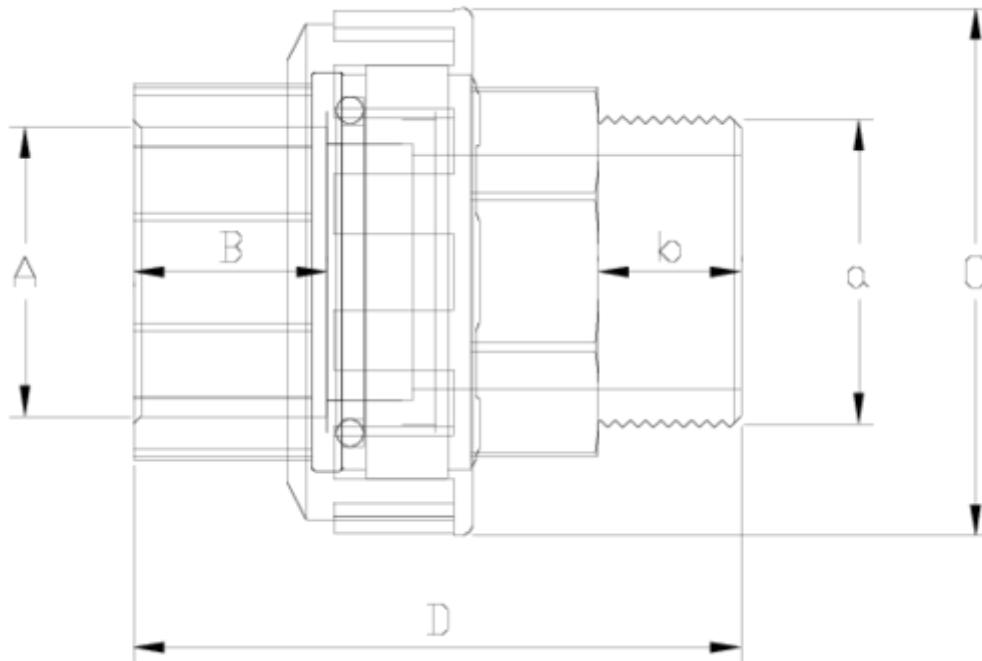

ITEM 030 | Union, plain socket - female thread socket, female threaded outlet

| Código | A-a | Peso (g) | B | b | C | D | PN | ROSCA |
|--------|---------------|----------|----|----|----|----|------|-------|
| 02515 | 1 1/2"-1 1/2" | 201 | 31 | 34 | 80 | 85 | PN10 | BSP |
| 02519 | 2"-1 1/2" | 314 | 38 | 34 | 98 | 95 | PN10 | BSP |



Product Documents



Product Certificates



Company Certificates

