



Accesorios de latón

Enlace 90° R/Macho

ITEM 153

| REFERENCIA | DESCRIPCIÓN | Peso neto | Volumen (m ³) | Peso bruto | Unidades lote |
|------------|----------------------------------|-----------|---------------------------|------------|---------------|
| 1020091 | CODO 90° R/MACHO LATON 20-1/2" | 0,1176 | 0,00892 | 7,245 | 60 |
| 1020092 | CODO 90° R/MACHO LATON 25-3/4" | 0,184065 | 0,00892 | 7,55 | 40 |
| 1020093 | CODO 90° R/MACHO LATON 32-1" | 0,296784 | 0,00892 | 7,607 | 25 |
| 1020094 | CODO 90° R/MACHO LATON 40-1 1/4" | 0,488258 | 0,02244 | 18,065 | 36 |
| 1020095 | CODO 90° R/MACHO LATON 50-1 1/2" | 0,745 | 0,02244 | 15,44 | 20 |
| 1020096 | CODO 90° R/MACHO LATON 63-2" | 1,238 | 0,01553 | 15,096 | 12 |
| 1020097 | CODO 90° R/MACHO LATON 75-2 1/2" | 1,831043 | 0,02244 | 13,305 | 7 |
| 1020098 | CODO 90° R/MACHO LATON 90-3" | 2,436 | 0,02244 | 10,284 | 4 |



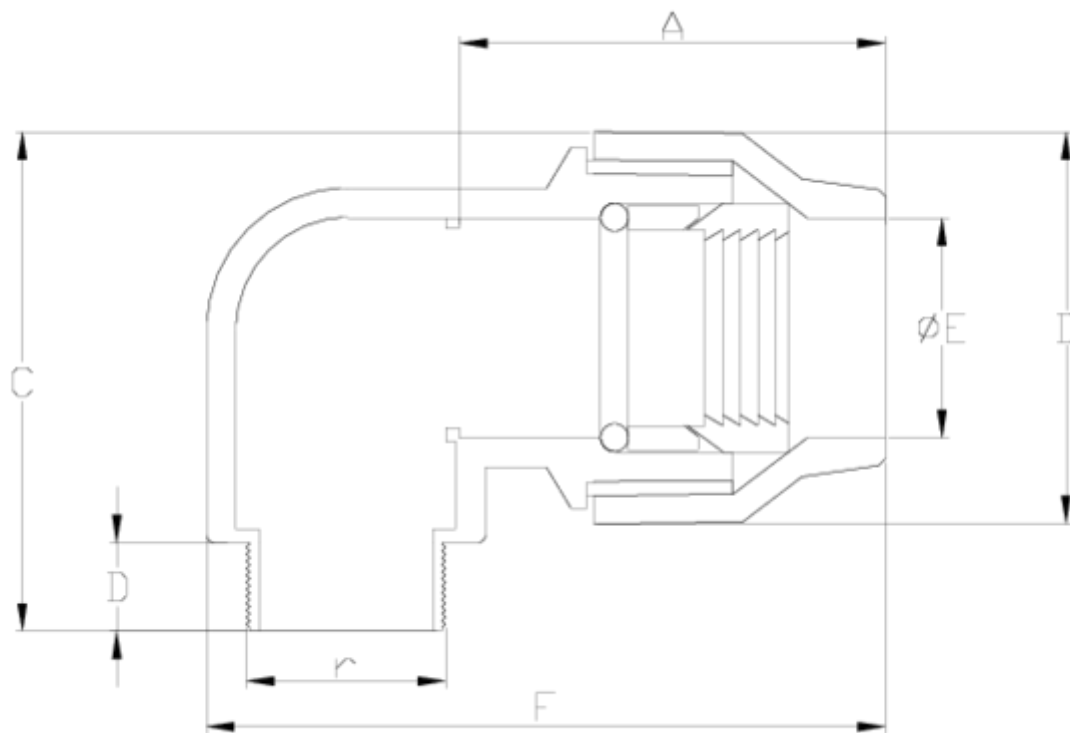

ITEM 153 | Enlace 90° R/Macho

| Código | f tubo-R | Peso (g) | A | B | C | D | E | F | r | PN | TIPO ROSCA |
|--------|-----------|----------|-----|------|-------|------|------|-----|--------|------|------------|
| 20091 | 20-1/2" | 125 | 31 | 35 | 42.5 | 9.2 | 21 | 55 | 1/2" | PN25 | BSP |
| 20092 | 25-3/4" | 208 | 35 | 41.5 | 51.6 | 11 | 26 | 68 | 3/4" | PN25 | BSP |
| 20093 | 32-1" | 272 | 42 | 49.5 | 63 | 14 | 33 | 75 | 1" | PN25 | BSP |
| 20094 | 40-1 1/4" | 496 | 50 | 61 | 76 | 13.5 | 41.8 | 96 | 1 1/4" | PN25 | BSP |
| 20095 | 50-1 1/2" | 745 | 52 | 74.3 | 95 | 14 | 51.2 | 108 | 1 1/2" | PN25 | BSP |
| 20096 | 63-2" | 1238 | 63 | 91.2 | 108 | 15 | 64 | 135 | 2" | PN25 | BSP |
| 20097 | 75-2 1/2" | 1735 | 135 | 95 | 110.8 | | | | | PN25 | BSP |
| 20098 | 90-3" | 2515 | 154 | 107 | 133.4 | | | | | PN25 | BSP |



Documentación de Producto

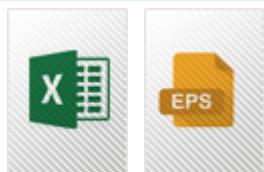

Certificados de Producto

Certificados de Empresa

