



Ventosas Net®

Triple efecto (D2) PPFV

ITEM 442

| REFERENCIA | DESCRIPCIÓN | Peso neto | Volumen (m ³) | Peso bruto | Unidades lote |
|------------|-----------------------------------|-----------|---------------------------|------------|---------------|
| 1017107 | VENTOSA NET TRIPLE EFECTO 3" PPFV | 1,0375 | 0,02244 | 6,713 | 6 |



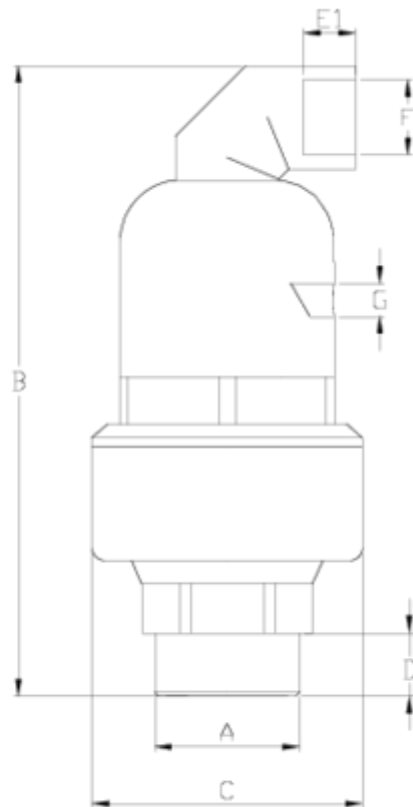

ITEM 442 | Triple efecto (D2) PPFV

| Código | f A | Peso (g) | B | C | D | E | F | G | Material | PN | TIPO ROSCA |
|--------|-----|----------|-----|-----|----|----|----|------|----------|------|------------|
| 17106 | 2" | 1045 | 260 | 112 | 30 | 21 | 1" | 3/8" | PPFV | PN16 | BSP |
| 17107 | 3" | 1085 | 260 | 112 | 33 | 21 | 1" | 3/8" | PPFV | PN16 | BSP |
| 17606 | 2" | 1084 | 260 | 112 | 30 | 21 | 1" | 3/8" | PA | PN25 | BSP |
| 17607 | 3" | 1124 | 260 | 112 | 33 | 21 | 1" | 3/8" | PA | PN25 | BSP |



Documentación de Producto



Certificados de Producto

Certificados de Empresa

